

38481 HURON RIVER DRIVE  
ROMULUS, MICHIGAN

INDUSTRIAL FOR SUBLEASE  
100,000-347,532 Square Feet Available



**SIGNATURE  
ASSOCIATES**  
KNOW SIGNATURE | KNOW RESULTS

## NORTHLINE INDUSTRIAL CENTER



### PROPERTY FEATURES

- 100,000 – 347,532 square feet available
- 1,500 square feet of office
- 23'-44' clear height
- (6) grade level doors, (9) truckwells
- (1) 15-ton & (1) 30-ton cranes
- 400+ paved parking spaces
- 7,000 amps, bus duct
- Excellent distribution/manufacturing location
- Active rail
- Close to Metropolitan Airport
- Lease Rate: \$4.95/sf NNN

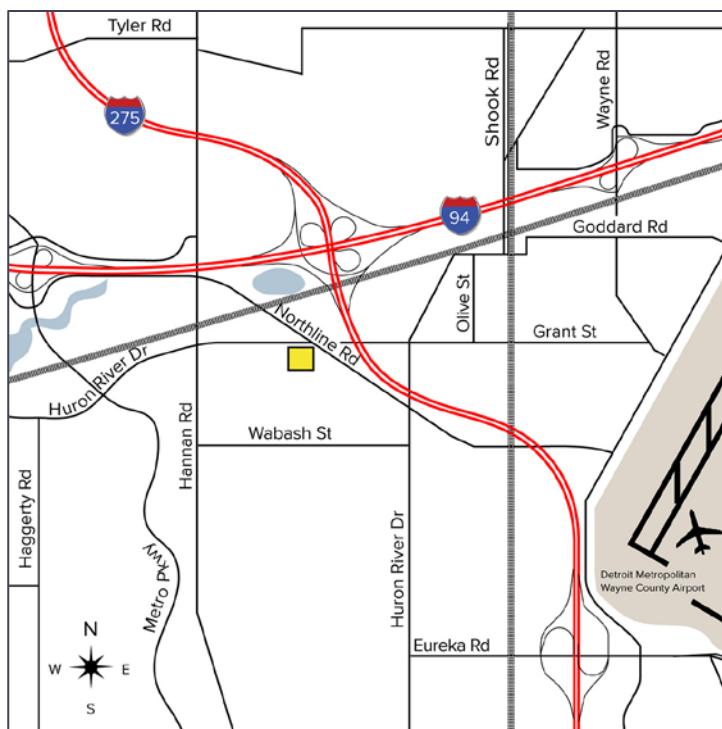

For more information, please contact:

**GREG HUDAS**  
(248) 799 3162

[ghudas@signatureassociates.com](mailto:ghudas@signatureassociates.com)

**JOE HAMWAY**  
(248) 948 0113

[jhamway@signatureassociates.com](mailto:jhamway@signatureassociates.com)

**SIGNATURE ASSOCIATES**  
One Towne Square, Suite 1200  
Southfield, MI 48076  
[www.signatureassociates.com](http://www.signatureassociates.com)

# 38481 Huron River Road - Romulus, Michigan

## Industrial For Sublease

100,000-  
347,532  
Square Feet  
AVAILABLE

### Site Plan

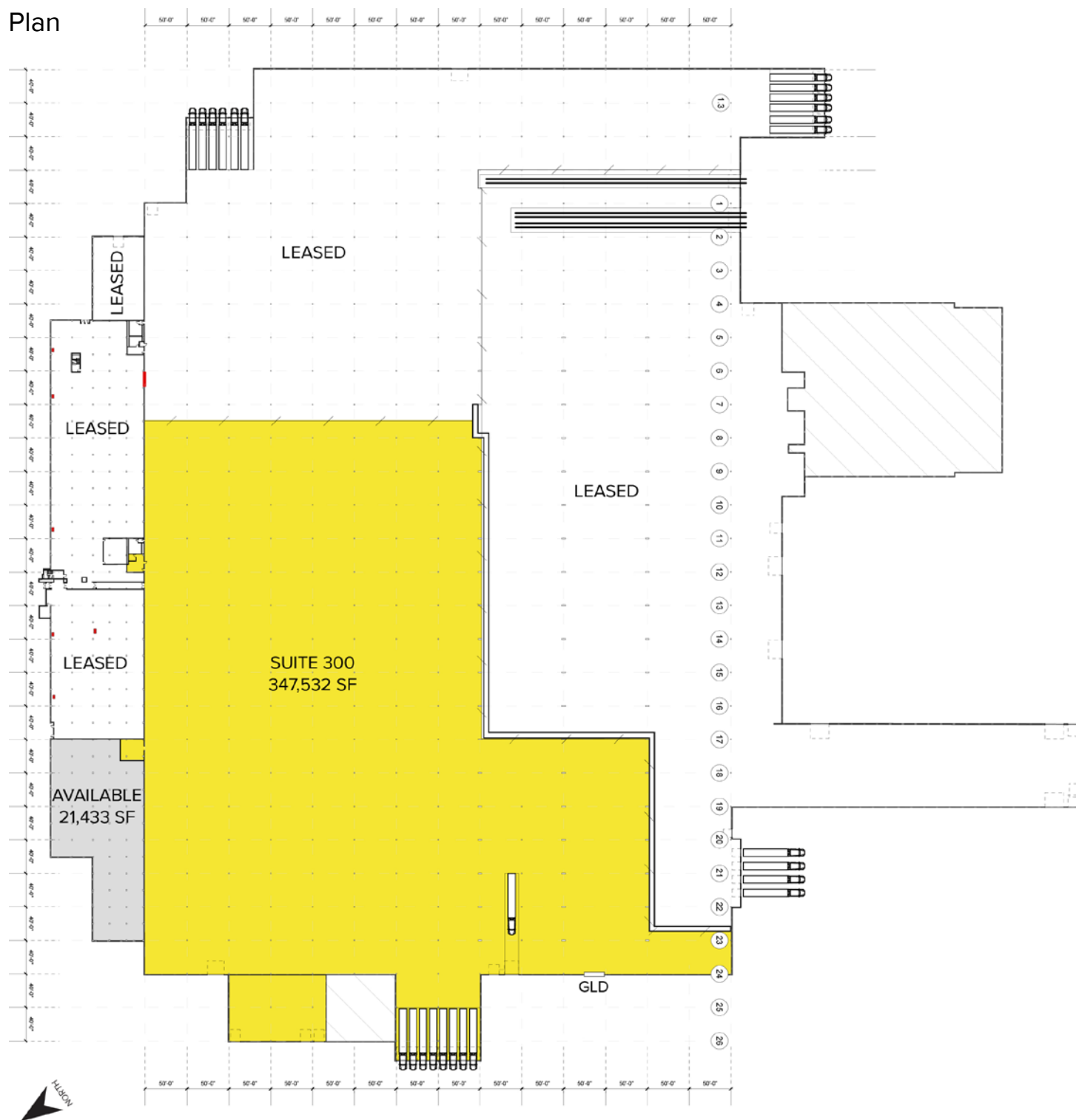

For more information, please contact:

**GREG HUDAS**

(248) 799 3162

ghudas@signatureassociates.com

**JOE HAMWAY**

(248) 948 0113

jhamway@signatureassociates.com

**SIGNATURE ASSOCIATES**

One Towne Square, Suite 1200

Southfield, MI 48076

www.signatureassociates.com

# 38481 Huron River Road - Romulus, Michigan

## Industrial For Sublease

100,000-  
347,532  
Square Feet  
AVAILABLE

Aerial



For more information, please contact:

**GREG HUDAS**

(248) 799 3162

[ghudas@signatureassociates.com](mailto:ghudas@signatureassociates.com)

**JOE HAMWAY**

(248) 948 0113

[jhamway@signatureassociates.com](mailto:jhamway@signatureassociates.com)

**SIGNATURE ASSOCIATES**

One Towne Square, Suite 1200

Southfield, MI 48076

[www.signatureassociates.com](http://www.signatureassociates.com)

Information is subject to verification and no liability for errors or omissions is assumed. Price is subject to change and listing withdrawal.