

6680–6730 MIDDLEBELT RD
ROMULUS, MICHIGAN

OFFICE/HI-TECH FOR LEASE
4,750 – 15,601 Square Feet Available



**SIGNATURE
ASSOCIATES**
KNOW SIGNATURE | KNOW RESULTS

METROPLEX COMMERCE CENTER



PROPERTY FEATURES

- 4,750 – 15,601 square feet available
- 30,707 square foot building
- Single story building built in 1989
- 124 total parking spaces
- Flexible industrial building currently built out for office use
- High image façade
- (5) Drive-in doors
- Close proximity to Middlebelt & I-94 exit
- Lease rate: \$5.75 - \$8.95/sf NNN



For more information, please contact:

BRAD VIERGEVER
(248) 799 3146
bviergever@signatureassociates.com

CHRIS SECONTINE
(248) 799 3174
csecontine@signatureassociates.com

SIGNATURE ASSOCIATES
One Towne Square, Suite 1200
Southfield, MI 48076
www.signatureassociates.com

6680-6730 Middlebelt Rd - Romulus, Michigan

Office/Hi-Tech For Lease

4,750 – 15,601
Square Feet
AVAILABLE

Site Plan

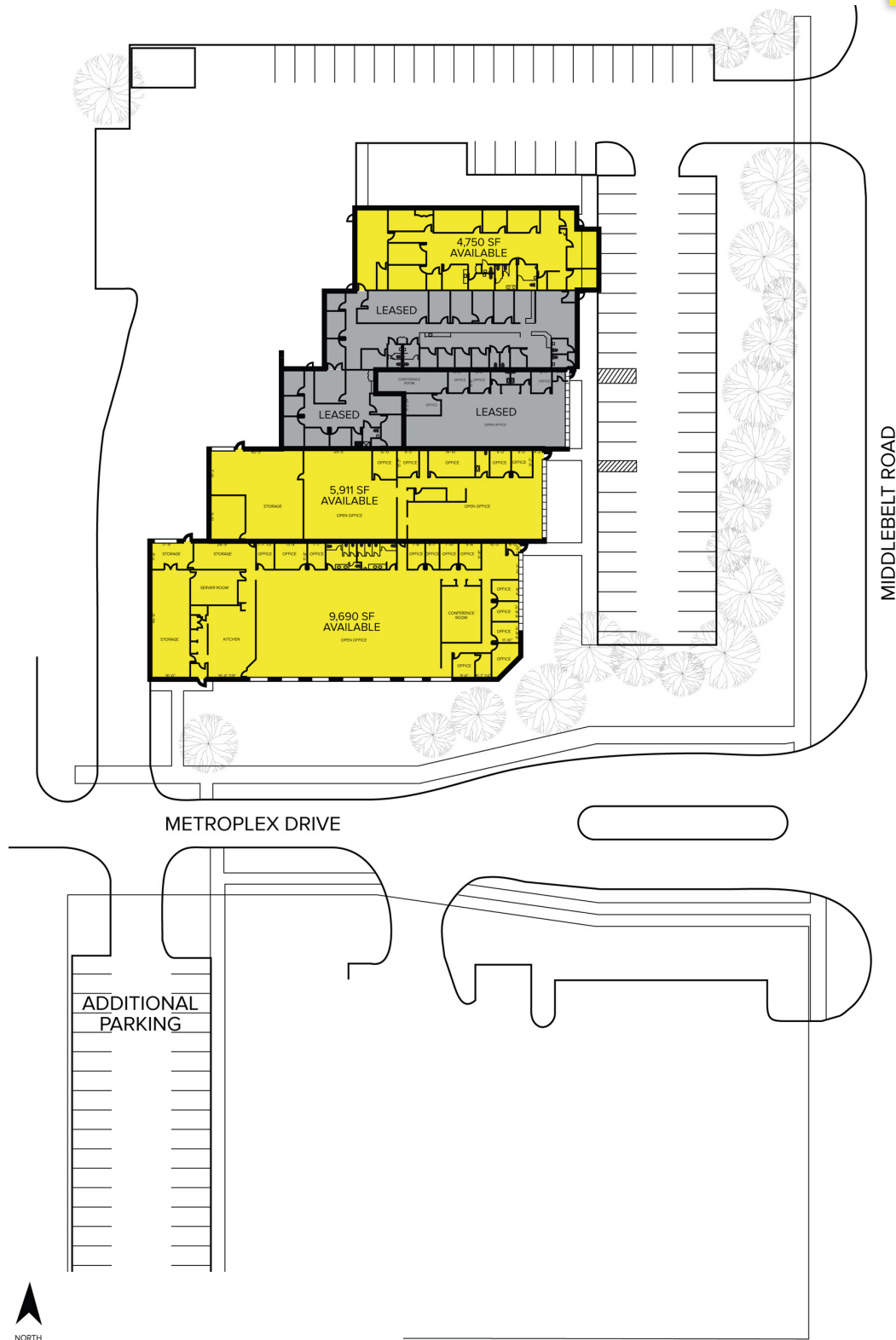

For more information, please contact:

BRAD VIERGEVER
(248) 799 3146
bviergever@signatureassociates.com

CHRIS SECONTINE
(248) 799 3174
csecontine@signatureassociates.com

SIGNATURE ASSOCIATES
One Towne Square, Suite 1200
Southfield, MI 48076
www.signatureassociates.com

Office/Hi-Tech For Lease

Floor Plan

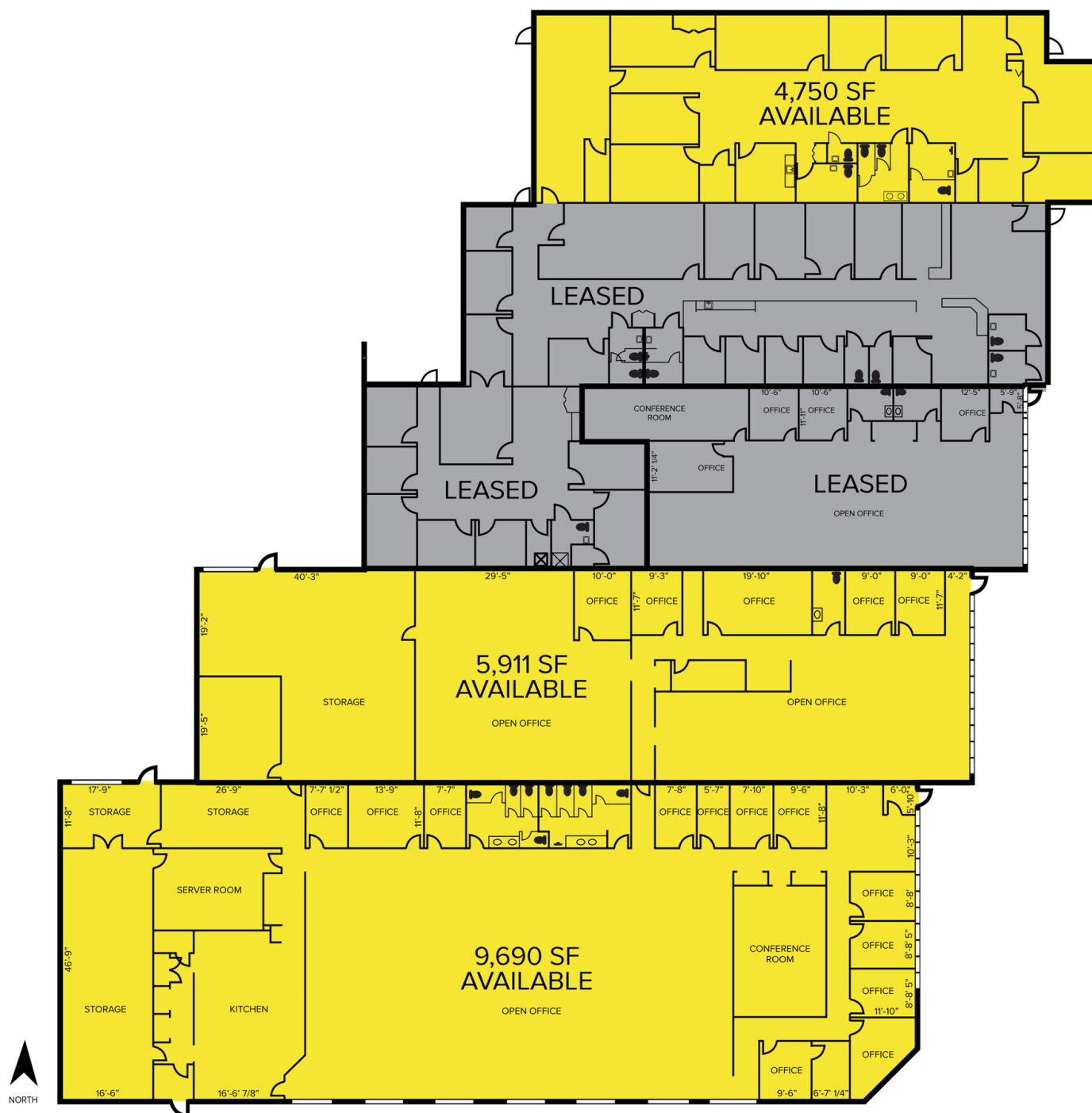

www.signatureassociates.com

Information is subject to verification and no liability for errors or omissions is assumed. Price is subject to change and listing withdrawal.